

GUIDE TO MOUNT YOUR PEEP SHOW ON A
WALL OR TREE

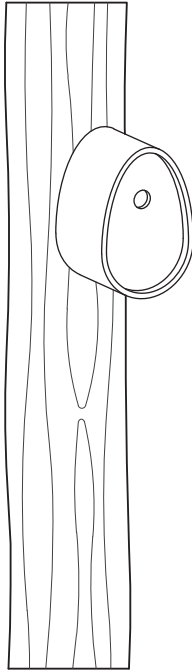



This **surface mounting** option should be used when a pole mount is not possible.

Consider your location carefully. Do not mount on structures with heavy foot traffic or where the opening and closing of doors may deter nesting.

Recommended mounting height is 8 to 10 feet off the ground.

Always use the included nylon spacers when mounting against a flat surface as this will allow important air circulation.

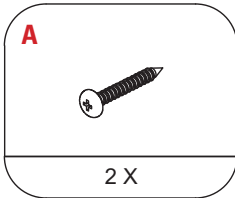

3" WOOD SCREWS

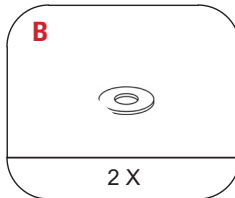

METAL WASHERS

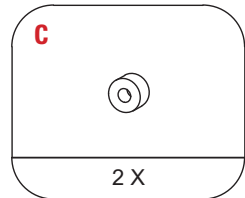

NYLON SPACERS

Note: Your Peep Show includes both a **POLE MOUNT** option and this **SURFACE MOUNT** option. The pole mount option may offer increased predator protection and allow better air circulation and is therefore the preferred mounting option whenever possible.

WALL OR TREE MOUNT

Step 01

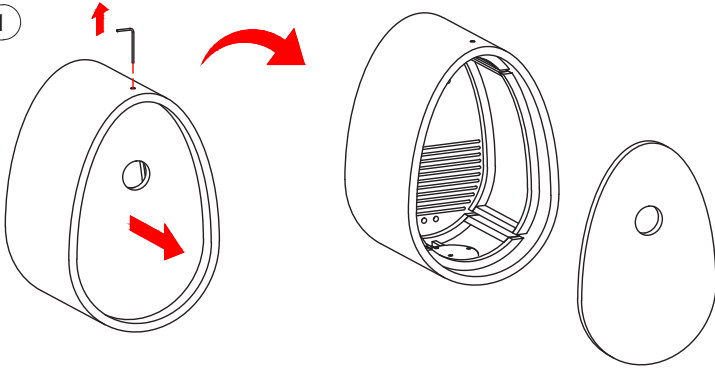

Step 02

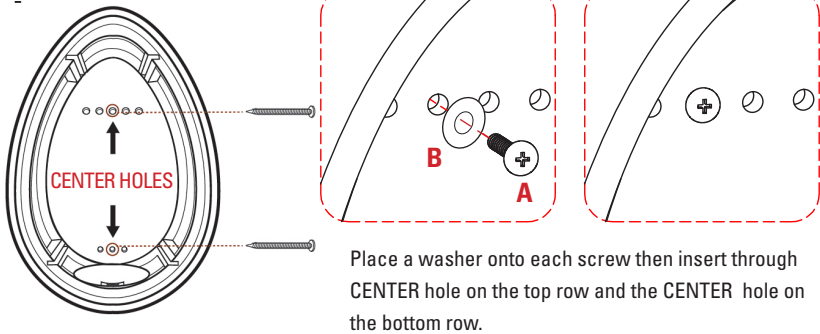

Step 03

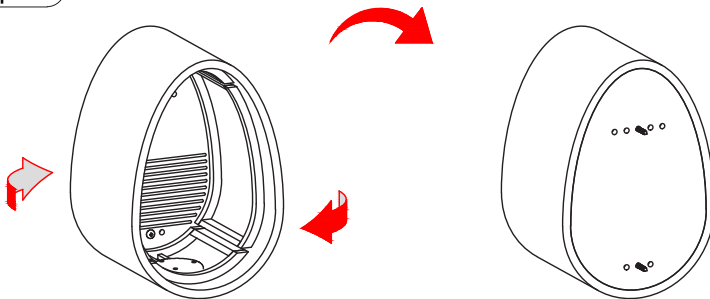

Flip nesting box around. Screws should extend about 2.5" out from the back of the nesting box.

WALL OR TREE MOUNT

Step 04

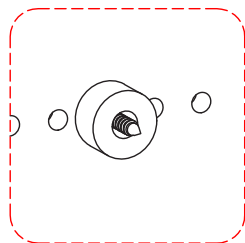
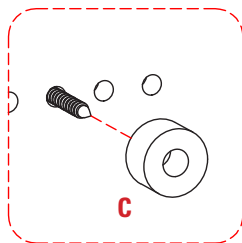
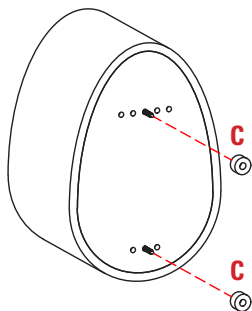

Always use the included nylon spacers when mounting against a flat surface as this will allow important air circulation to keep the nest cooler.

Step 05

